

FILE NO. 80-1514152  
 DATE: 2-3-81  
 DRAWN BY: J. HARRISLEY  
 R.M.C.



Plat filed this 2 day of April 1981  
 and Registered in Vol. 1514152  
 Book 80-1514152  
 Greenville County, S.C.

PREPARED BY: J. HARRISLEY  
 REGISTERED PROFESSIONAL SURVEYOR  
 LICENSE NO. 11383

CURVE TABLE - SECTION II

STATION	CHORD BEARING	CH. DISTANCE	DELTA	ARC LENGTH
16	N49-15-30E	52.72	11-04-27	52.80
17	N42-31-03E	96.59	149-59-19	130.89
18	N21-58-50E	96.59	149-59-19	130.89
19	N51-58-50E	96.59	149-59-19	130.89
20	N39-34E	29.12	5-09-51	29.13
21	N49-15E	80.00	14-13-08	80.21
22	N61-42E	80.00	10-39-08	80.00
23	N44-59-33W	187.22	39-30-54	190.98
24	N63-41-39W	100.00	8-19-12	100.09
25	N55-55-57W	85.00	7-04-13	85.05
26	N40-32-38W	85.00	7-04-13	85.05
27	N35-58-35W	87.26	7-15-31	87.32
28	N40-32-38W	82.55	7-04-13	82.60
29	N27-43-05W	85.00	7-04-13	85.05
30	N20-38-52W	85.00	7-04-13	85.05
31	N00-05-02W	24.90	12-06-37	24.90
32	N16-04-39W	60.78	2-04-12	60.89
33	N00-05-02W	42.68	8-29-45	42.72
34	N44-46-58W	51.13	61-30-03	53.67
35	N14-10-49E	47.27	56-25-10	49.24
36	N73-23-35E	50.00	60-00-00	52.36
37	N47-36-25W	50.00	60-00-00	52.36
38	N01-34-13W	27.63	32-04-44	27.99
39	N04-37-08E	31.45	19-41-48	31.85
40	N20-31-04W	111.02	9-57-47	111.16
41	N32-35-52W	155.00	13-55-36	153.38
42	N44-02-50W	100.00	8-58-19	100.19
43	N56-26-44W	176.00	15-49-29	176.86
44	N63-06-22W	39.00	3-29-46	39.01
45	N64-32-54W	37.70	6-36-39	37.72
46	N53-19-50W	90.00	15-49-29	90.29
47	N29-29-64W	60.00	8-23-47	60.20
48	N27-40-23W	49.77	6-23-47	49.87
49	N43-58-08E	55.04	81-08-37	70.81
50	N58-18-21W	60.39	74-17-58	64.84
51	N08-50-47E	50.00	60-00-00	52.36
52	N81-07-16E	67.27	84-33-06	73.79
53	N33-14-36W	75.68	20-31-11	76.09
54	N51-29-06W	59.00	14-57-48	59.19
55	N65-46-28W	55.19	14-36-52	55.34
56	N43-58-08E	55.04	81-08-37	70.81
57	N58-18-21W	60.39	74-17-58	64.84
58	N08-50-47E	50.00	60-00-00	52.36
59	N81-07-16E	67.27	84-33-06	73.79
60	N33-14-36W	75.68	20-31-11	76.09
61	N51-29-06W	59.00	14-57-48	59.19
62	N65-46-28W	55.19	14-36-52	55.34
63	N43-58-08E	55.04	81-08-37	70.81
64	N58-18-21W	60.39	74-17-58	64.84
65	N08-50-47E	50.00	60-00-00	52.36
66	N81-07-16E	67.27	84-33-06	73.79
67	N33-14-36W	75.68	20-31-11	76.09
68	N51-29-06W	59.00	14-57-48	59.19
69	N65-46-28W	55.19	14-36-52	55.34
70	N43-58-08E	55.04	81-08-37	70.81
71	N58-18-21W	60.39	74-17-58	64.84
72	N08-50-47E	50.00	60-00-00	52.36
73	N81-07-16E	67.27	84-33-06	73.79
74	N33-14-36W	75.68	20-31-11	76.09
75	N51-29-06W	59.00	14-57-48	59.19
76	N65-46-28W	55.19	14-36-52	55.34
77	N43-58-08E	55.04	81-08-37	70.81
78	N58-18-21W	60.39	74-17-58	64.84
79	N08-50-47E	50.00	60-00-00	52.36
80	N81-07-16E	67.27	84-33-06	73.79
81	N33-14-36W	75.68	20-31-11	76.09
82	N51-29-06W	59.00	14-57-48	59.19
83	N65-46-28W	55.19	14-36-52	55.34
84	N43-58-08E	55.04	81-08-37	70.81
85	N58-18-21W	60.39	74-17-58	64.84
86	N08-50-47E	50.00	60-00-00	52.36
87	N81-07-16E	67.27	84-33-06	73.79
88	N33-14-36W	75.68	20-31-11	76.09
89	N51-29-06W	59.00	14-57-48	59.19
90	N65-46-28W	55.19	14-36-52	55.34

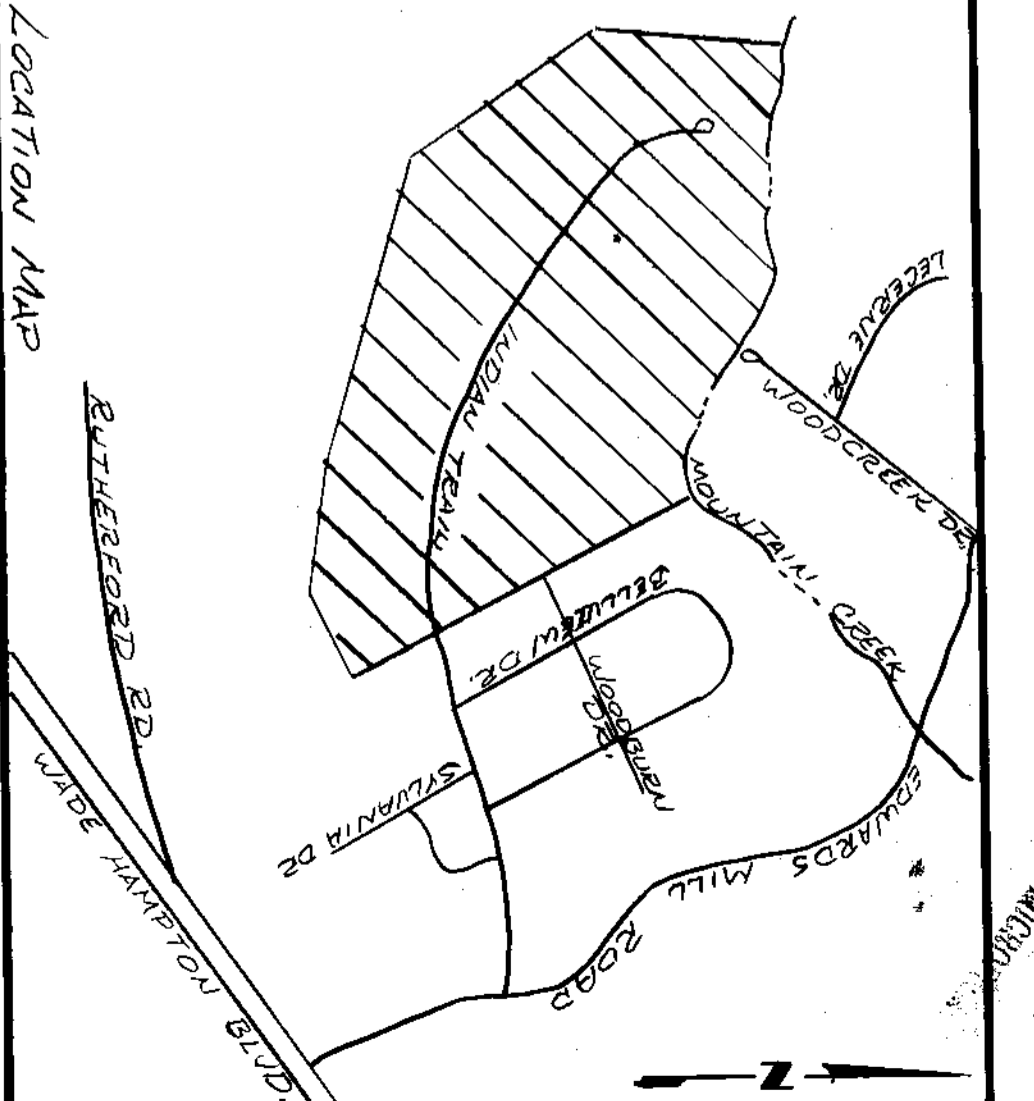

# FINAL PLAT

## CERTIFICATE OF OWNERSHIP AND DEDICATION

"I, the undersigned, hereby acknowledge that I am (we and the owner(s) of the property shown and described hereon and that I (we) hereby adopt this plat of subdivision with my (our) free consent and that I (we) establish the minimum building restriction lines, and hereby dedicate to public use as roads, streets, and easements, forever, all areas so shown or indicated on said plat.

4/2/81  
 Signed: *Edward W. Blackmore*  
 Licensed Engineer or Registered Surveyor

## CERTIFICATE OF ACCURACY

"I, RE BLACKMORE, certify that this plat was (drawn-by-me) (drawn under my supervision) (prepared-by-me-and-under-my-supervision) from (an actual survey made by-me) (other) and that the error of closure as calculated by (the method used) (other) is: 1:5000.00. I further certify that the boundaries and depicted from information found in Book \_\_\_\_\_ Page \_\_\_\_\_ that this plat was prepared in accordance with the Greenville County Subdivision Regulations as adopted.

Feb 6 1981  
 Signed: *Donald E. Blackmore*  
 LICENSED ENGINEER OR REGISTERED SURVEYOR

## CERTIFICATE OF APPROVAL FOR RECORDING

"I hereby certify that the subdivision plat shown hereon has been found to comply with the Subdivision Regulations for Greenville County, with the exception of such variances, if any, as are noted in the minutes of the Greenville County Planning Commission of Greenville County, South Carolina, and that it has been approved for recording in the office of the County Register of Deeds Greenville County, South Carolina."

4/2/81  
 Signed: *J. James Fisher*  
 DIRECTOR OF PLANNING  
 GREENVILLE COUNTY PLANNING COMMISSION

FILE NUMBER  
**80-1514152**

FOREST ACRES  
 SECTION II

PORTIS CORPORATION  
 GREENVILLE, S.C.  
 HEANER ENGR. CO., INC.  
 GREENWOOD, S.C.

DATE: 2-3-81  
 NO. OF LOTS: 46  
 DATE: 4/19/81  
 MILES: 0.36

NOTE: All lots to have a minimum of 10,000 sq. ft. of area and a minimum of 10,000 sq. ft. of area. All lots to have a minimum of 10,000 sq. ft. of area and a minimum of 10,000 sq. ft. of area.

NOTE: The 100 year Flood Boundary and Floodway as shown have been established from data furnished by the Army Corps of Engineers, or other data as shown on the plan. The Flood Boundary and Floodway as shown are for informational purposes only and do not constitute a warranty of any kind.



RECORDING FEE  
 PAID \$ 5.00

7-1-84

27772

N/F NITEX INC

N/F LONG

EDWARDS FOREST SUBDIVISION

N/F CUNNINGHAM

SECTION I

SECTION I

SECTION I

SECTION I

SECTION I